

Bathroom drain collection

UperfilDesign

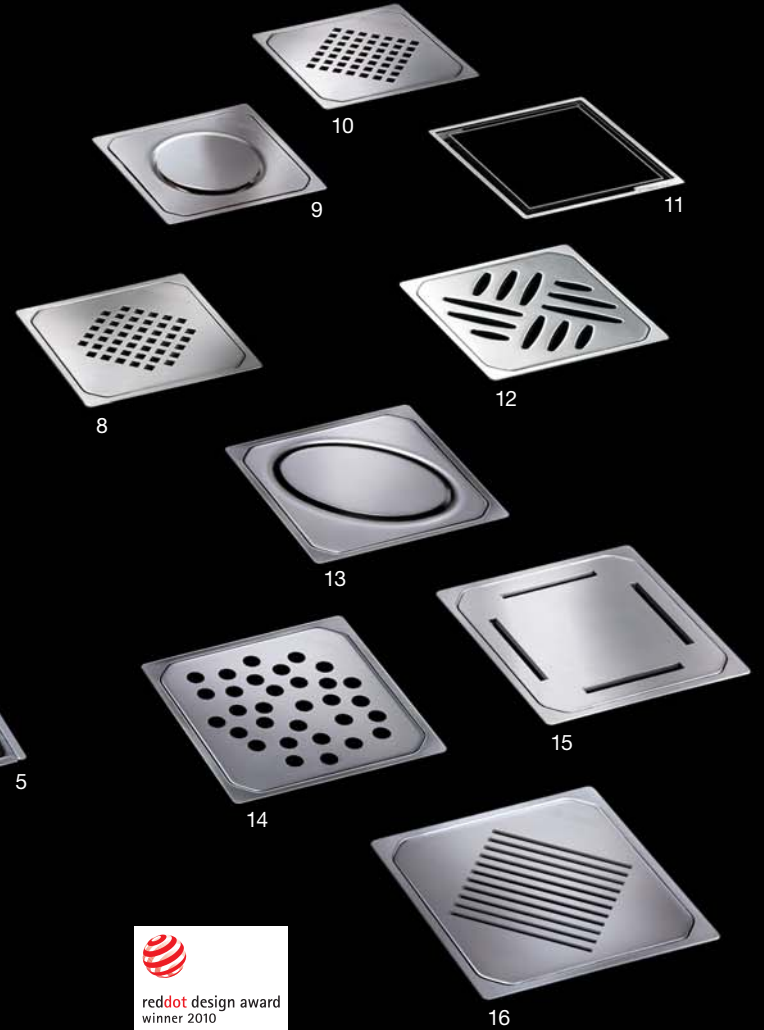

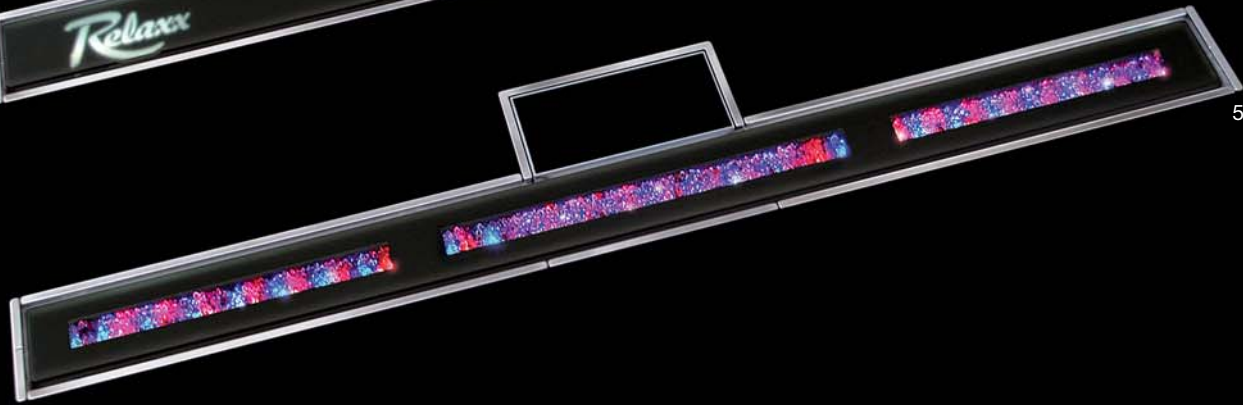
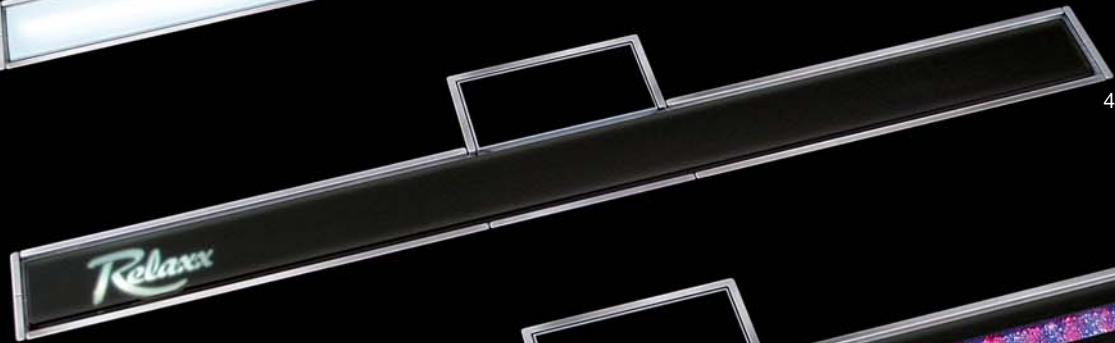
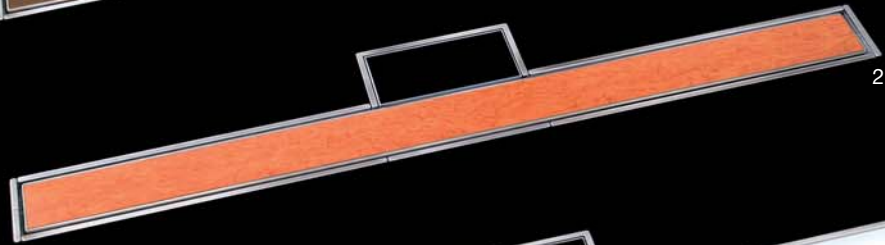

Channel inserts for shower channel

„LINEA“ Super 60 Individual

- 1 Wengé
- 2 Burl wood
- 3 DuPont™ Corian® illuminated
- 4 Individual channel insert („Logo“ example)
- 5 Individual channel insert (made with CRYSTALLIZED™-Swarovski Elements)

„LINEA“ shower channel

- 6 „LINEA“ slim and elegant stainless steel cover
- 7 „LINEA“ Super 60 stainless steel cover (reversible and tilable) high drainage capacity access opening

Design covers

- 8 *Design cover Cross* made of stainless steel, with or without Lock & Lift system
- 9 *Design cover Spot* made of stainless steel, with or without Lock & Lift system
- 10 *Design cover Parade* made of stainless steel, with or without Lock & Lift system
- 11 *„Invisible“ cover* recessed for on-site tiling, with locking system
- 12 *Design cover Kessel* made of stainless steel, with or without Lock & Lift system
- 13 *Design cover Oval* made of stainless steel, with or without Lock & Lift system
- 14 *Design cover Festival* made of stainless steel, with or without Lock & Lift system
- 15 *Design cover Slot* made of stainless steel, mit oder ohne Lock & Lift-System
- 16 *Design cover Sticks* made of stainless steel, with or without Lock & Lift system

UperfilDesign

Modern bathrooms are barrier-free. Flush-to-floor showers create a whole new space experience in bathrooms. The shower is no longer somewhere you struggle to get into in order to put yourself through a routine washing process. In addition to design aspects, this new way of showering also makes extremely tough demands on the functionality of the drain. Only maximum flow rate and unlimited servicing possibilities can guarantee a safe function.

For more than 45 years now, KESSEL has been presenting innovations in draining technology. The products in our „KesselDesign“ range combine the technical know-how that comes from long years at the top of the market with a conscious high-quality design understatement. Unconditional functionality is at the beginning of every product development process. Only high-quality materials, stainless steel and impact-resistant plastic can meet these requirements. The result is the combination of an unwillingness to compromise on the technical side and an aesthetic attractive appearance, high draining capacities, straightforward access during cleaning and comprehensive accessories.



reddot design award
winner 2010

The UperfillDesign covers received the international red dot award in the category Product Design for their unmatched design quality.

DESIGN PLUS

At the „ISH“ in Frankfurt, the world's leading trade fair for bathrooms as well as domestic and energy technology, our „Oval“ design cover won the „DESIGN PLUS Award“.



„LINEA“ Super60 shower channel in stainless steel



„LINEA“ Super60 shower channel with tiled cover

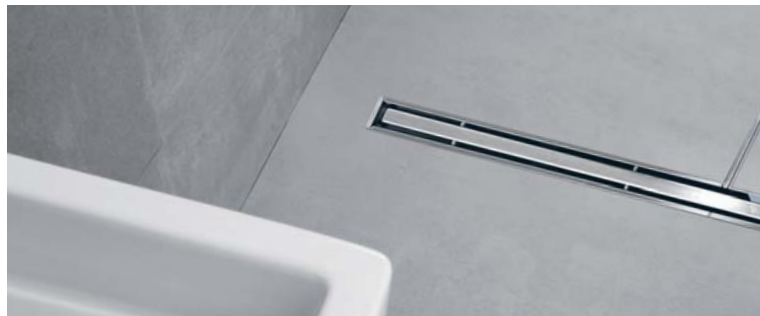

„LINEA“ in stainless steel

Design
**right down
the line**

„LINEA“ Super 60

Shower channel with stainless steel cover, reverse side tilable

Uperfil venting siphon





Wengé channel insert



Burl wood channel insert



DuPont™ Corian® illuminated channel insert

Variations
for more
creativity

„LINEA“ Super 60 Individual

with custom channel insert



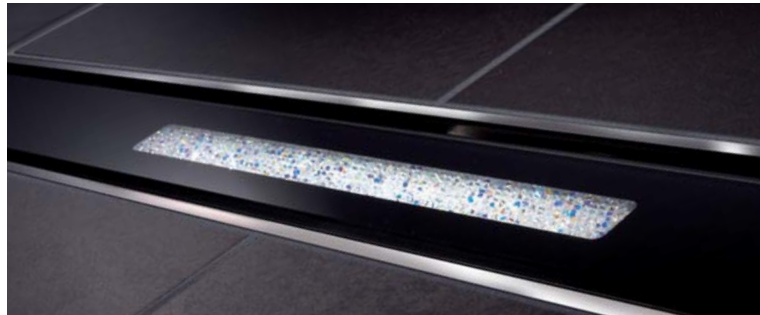

Individual channel insert (made with CRYSTALLIZED™-Swarovski Elements)



Individual channel insert (for example with custom engraved logo)

Space for individual ideas

Customized „Individual“ models are a real highlight of course.

Decorative elements that really leave their mark on a bathroom such as coloured glass stones, dried flowers or other small accessories can be inserted in the illuminated glass insert, or company logos, such as the name of a hotel, are also possible.

There are no limits to fantasy and creativeness, and a consistently high-quality bathroom design can be perfectly realized, right down to the last detail.



„LINEA“ Super 60 Individual

Shower channel with custom engraved logo, illuminated

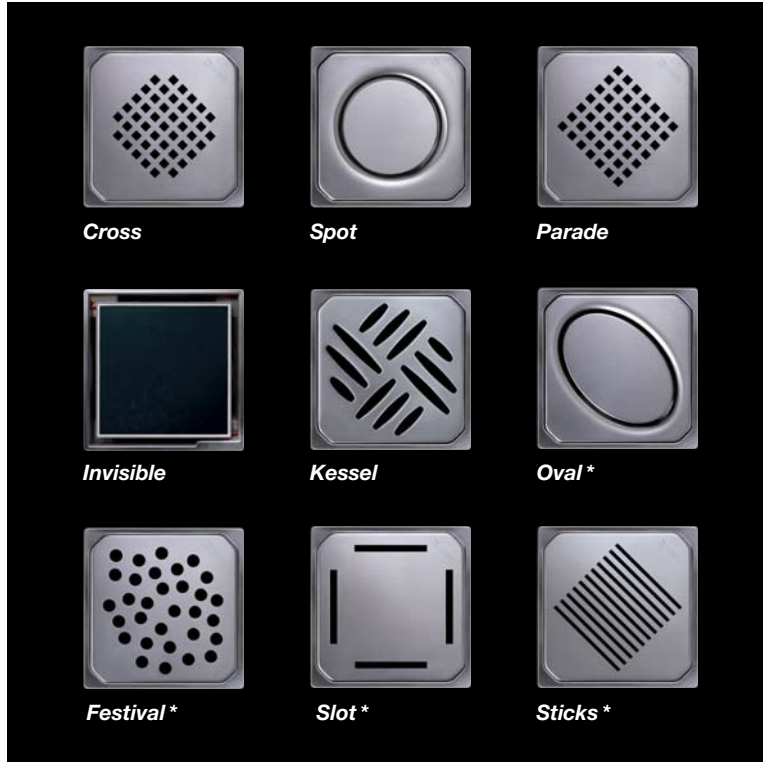
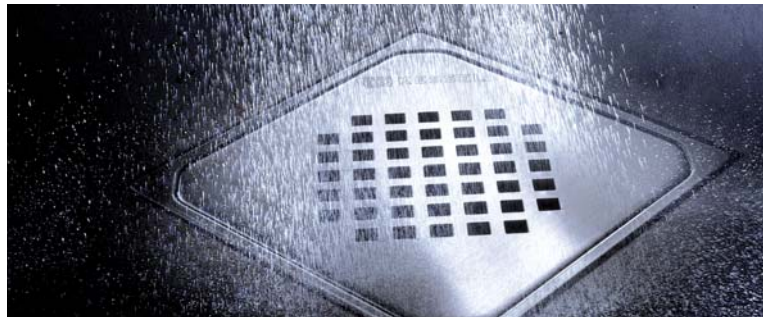

Design **in a nutshell**



* red dot design award
winner 2010



Design cover bathroom drains

Oval cover with Lock & Lift system

Modular system for „LINEARIS“ System 125 shower channels

1 „LINEA“

- Flow rate with counter slope up to 24 litres per minute
- „Invisible“ access opening can be locked and tiled
- Rim and channel insert made of stainless steel
- Ideal for installation on wall side
- Lengths: L1: 750 mm, L2: 850 mm, L3: 950 mm, L4: 1150 mm

2-5 „LINEA“ Super60

- Flow rate with counter slope up to 72 litres per minute
- „Invisible“ access opening can be locked and tiled
- Rim and channel insert made of stainless steel
- Channel insert can be turned and tiled
- Selection of individual channel inserts for more design freedom
- Installation on wall or room side
- Also suitable for natural floor coverings up to 20 mm
- Lengths: L1: 750 mm, L2: 850 mm, L3: 950 mm, L4: 1150 mm

6-7 „LINEA“ Super60 Individual

- Sizes and technical details as „LINEA“ Super60
- Custom-made to individual wishes (with LED lighting)
- Illuminated channel inserts with maintenance-free induction technology and minimum power consumption

Shower channels

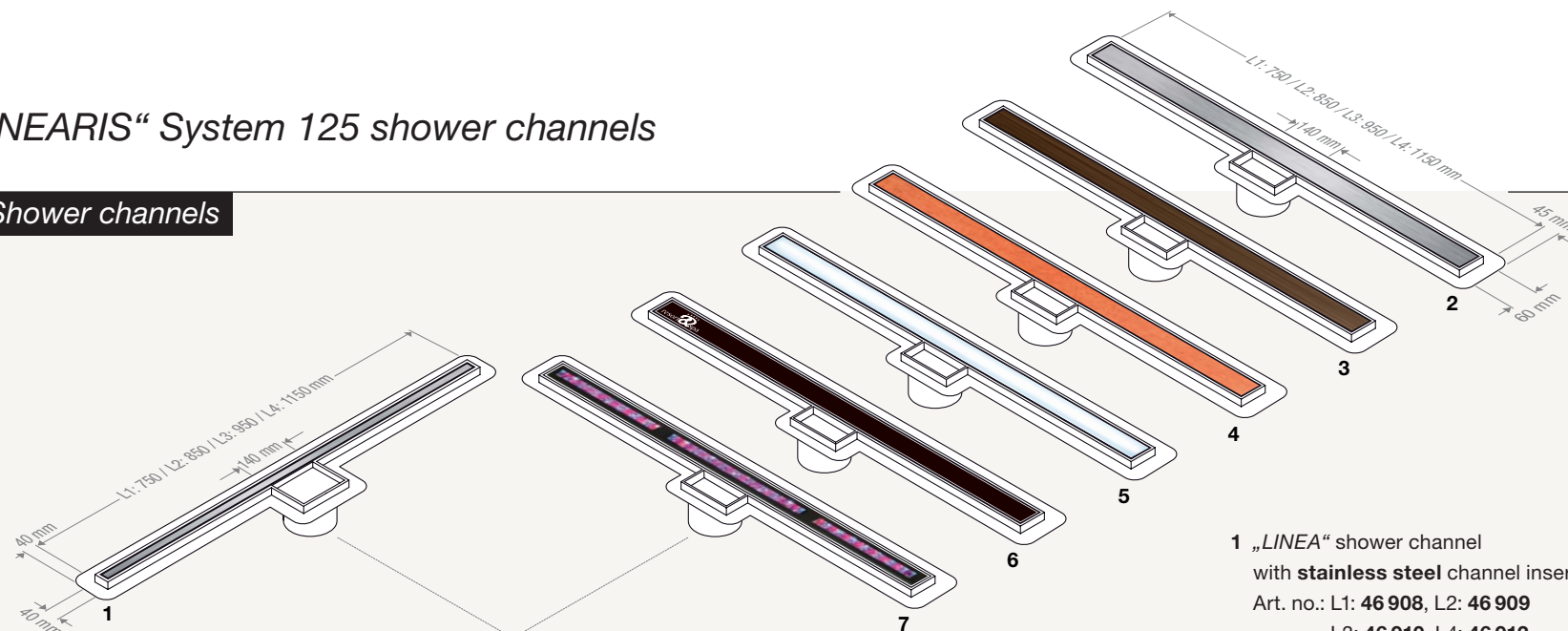

1 „LINEA“ shower channel with stainless steel channel insert
Art. no.: L1: 46 908, L2: 46 909
L3: 46 910, L4: 46 912

Accessories

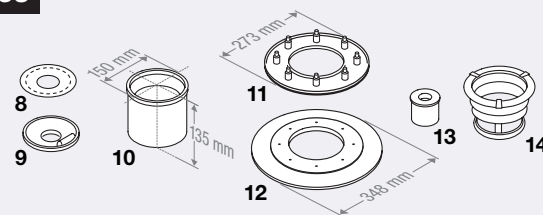

8 Hair sieve
Art. no.: 48 700

10 Extension
Art. no.: 48 987

9 Multistop
Odour, foam and rodent stop
Art. no.: 48 500

11 Pressure sealing flange
Art. no.: 48 402
suitable for the elastomer sealing sheet (Art. no.: 48 981)

Drain bodies

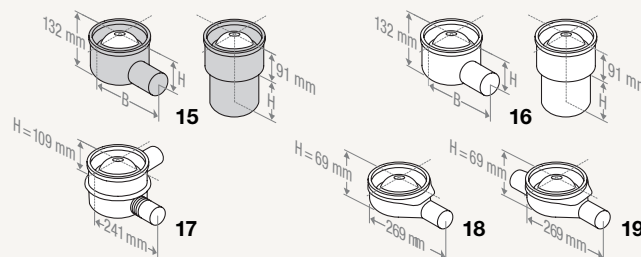

15 Drain made of **Ecoguss®**

Side outlet ¹⁾			
Ø	Art. no.	B	H
58	48 358	245	120
78	48 378	134	109
83	48 383	134	108
110	48 311	148	92
Outlet vertical ¹⁾			
Ø	Art. no.	H	
58	48 458	100	
78	48 478	110	
83	48 483	110	
110	48 411	110	

16 **Practicus®** made of PP

Side outlet ¹⁾			
Ø	Art. no.	B	H
50	45 150	245	120
75	45 170	134	109
110	45 110	148	92
Outlet vertical ¹⁾			
Ø	Art. no.	H	
50	45 250	100	
75	45 270	110	
110	45 210	110	

¹⁾ Flow rate 1.8 l/s

2 „LINEA“ Super60 shower channel with **stainless steel** channel insert
Art. no.: L1: **48 908**, L2: **48 909**
L3: **48 910**, L4: **48 912**

3 „LINEA“ Super60 Individual shower channel with **Wengé** channel insert
Art. no.: L1: **48 908 IW**, L2: **48 909 IW**,
L3: **48 910 IW**, L4: **48 912 IW**

4 „LINEA“ Super60 Individual shower channel with **burl wood** channel insert
Art. no.: L1: **48 908 IH**, L2: **48 909 IH**,
L3: **48 910 IH**, L4: **48 912 IH**

5 „LINEA“ Super60 Individual shower channel with **DuPont™ Corian®** illuminated channel insert
Art. no.: L1: **48 908 IC**, L2: **48 909 IC**,
L3: **48 910 IC**, L4: **48 912 IC**

6 „LINEA“ Super60 Individual shower channel with „**custom-made**“ illuminated channel insert (e.g. with logo, emblem etc. for hotels, ...), **on request**

7 „LINEA“ Super60 Individual shower channel with „**custom-made**“ illuminated channel insert, cavities can be filled e.g. with CRYSTALLIZED™ Swarovski Elements, **on request**

12 Adhesive flange
Art. no.: **48 410**

13 Fire-Kit fire protection only for drain bodies **Ecoguss® / Practicus®** with vertical outlet
Art. no.: **48 100**

14 Quick Fit all-round seal for core drilling (only for drain bodies **Ecoguss®** and **Practicus®** with vertical outlet)
• with fire protection art. no.: **48 990**
• without fire protection art. no.: **48 991**

17 Bathroom drain **Giro** made of PP,
Side outlet Ø 50, side inlet Ø 50,
Flow rate 1,3 l/s
Art. no.: **45 101**

18 Bathroom drain „**Ultraflat**“ made of ABS,
Side outlet Ø 50, Ø 75,
Flow rate 1.0 l/s
Art. no.: Ø 50: **45 700**, Ø 75: **45 770**

19 Bathroom drain „**Ultraflat**“ made of ABS,
Side outlet Ø 50, side inlet Ø 40,
Flow rate 1.0 l/s
Art. no.: **45 701**

Technology



Illuminated channel insert DuPont™ Corian® with maintenance-free induction technology and minimum power consumption – no need to charge the battery

Cleaning



Channel insert, cover for service access and odour trap can be removed easily

Installation examples

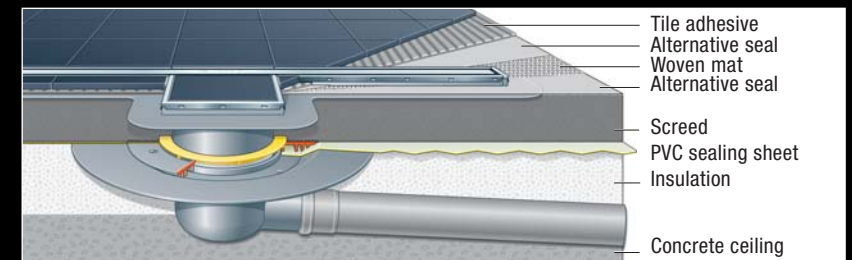

Conventional seal using sheeting

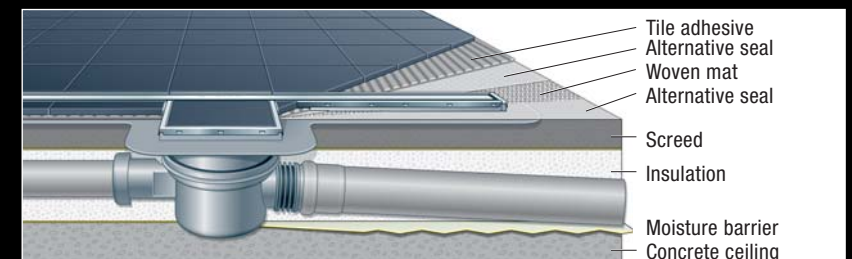

Thin mortar bed seal using channel flange

Modular system for System 125 bathroom drains

Upper section

- Stainless steel frame
- Frame size 132 x 132 mm

„Invisible“ cover can be tiled

- Size 110 x 110 mm
- Lockable
- Load class K3
(for max. load of 300 kg)

„Design“ covers

- Made of solid stainless steel
- Size 120 x 120 mm
- Lock & Lift system for simultaneous unlocking and removal of the cover for straightforward cleaning
- Can be ordered with or without Lock & Lift system
- Load class K3
(for max. load of 300 kg) for the design covers Spot, Festival, Cross, Parade, Slot and Sticks
- Load class L15
(for max. load of 1.5 t) for the design covers Oval and Kessel

Upper section with drain cover

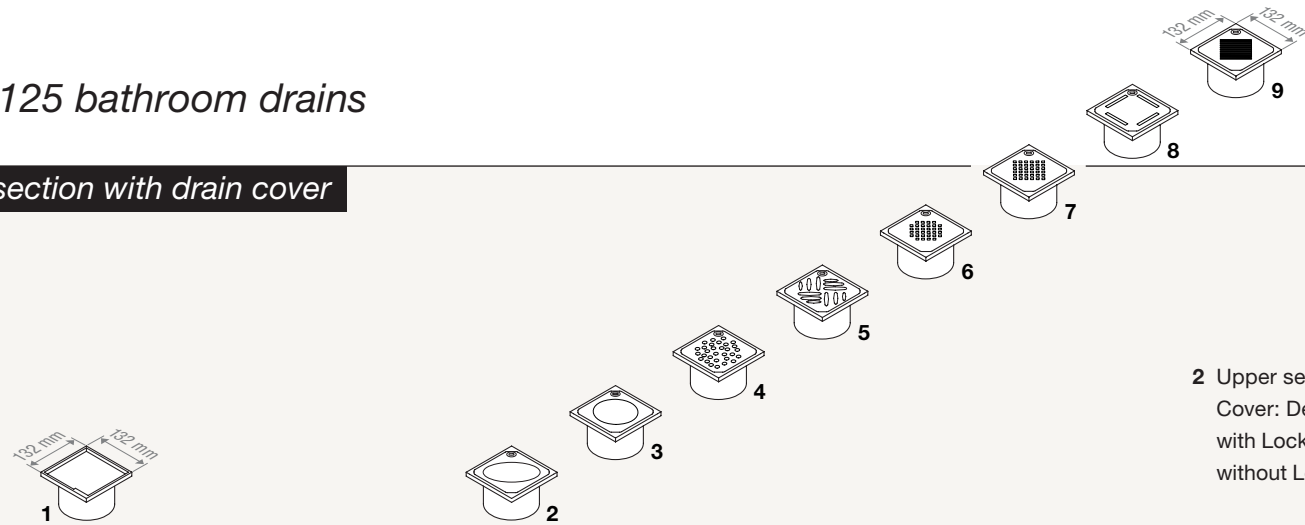

1 Upper section made of ABS, „Invisible“ cover can be tiled with locking system
Art. no. **48 211**

2 Upper section made of ABS, Cover: Design cover **Oval** with Lock & Lift: Art. no. **48 202** without Lock & Lift: Art. no. **48 226**

3 Upper section made of ABS, Cover: Design cover **Spot** with Lock & Lift: Art. no. **48 221** without Lock & Lift: Art. no. **48 220**

Accessories

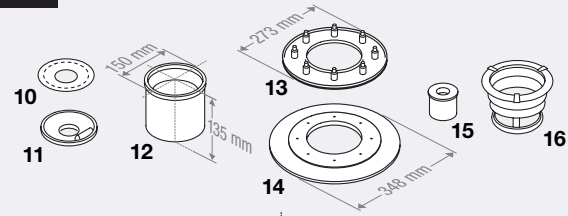

10 Hair sieve
Art. no.: **48 700**

12 Extension
Art. no.: **48 987**

11 Multistop
Odour, foam and rodent stop
Art. no.: **48 500**

13 Pressure sealing flange
Art. no.: **48 402**
suitable for the elastomer sealing sheet (Art. no.: **48 981**)

Drain bodies

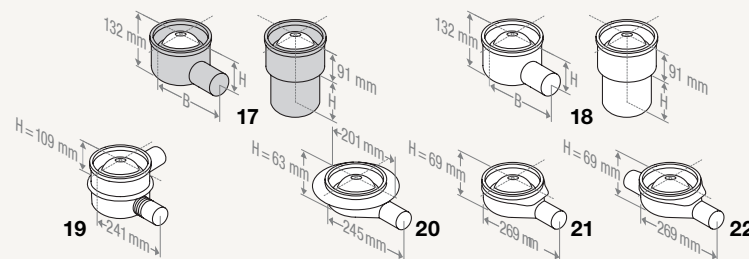

17 Drain made of **Ecoguss®**

Side outlet ¹⁾			
Ø	Art. no.	B	H
58	48 358	245	120
78	48 378	134	109
83	48 383	134	108
110	48 311	148	92
Outlet vertical ¹⁾			
Ø	Art. no.	H	
58	48 458	100	
78	48 478	110	
83	48 483	110	
110	48 411	110	

18 **Practicus®** made of PP

Side outlet ¹⁾			
Ø	Art. no.	B	H
50	45 150	245	120
75	45 170	134	109
110	45 110	148	92
Outlet vertical ¹⁾			
Ø	Art. no.	H	
50	45 250	100	
75	45 270	110	
110	45 210	110	

¹⁾ Flow rate 1.8 l/s

4 Upper section, ABS
Cover: Design cover **Festival**
with Lock & Lift: Art. no. **48 215**
without Lock & Lift: Art. no. **48 214**

5 Upper section, ABS
Cover: Design cover **Kessel**
with Lock & Lift: Art. no. **48 201**
without Lock & Lift: Art. no. **48 225**

6 Upper section, ABS
Cover: Design cover **Cross**
with Lock & Lift: Art. no. **48 213**
without Lock & Lift: Art. no. **48 212**

7 Upper section, ABS
Cover: Design cover **Parade**
with Lock & Lift: Art. no. **48 224**
without Lock & Lift: Art. no. **48 223**

8 Upper section, ABS
Cover: Design cover **Slot**
with Lock & Lift: Art. no. **48 219**
without Lock & Lift: Art. no. **48 218**

9 Upper section, ABS
Cover: Design cover **Sticks**
with Lock & Lift: Art. no. **48 217**
without Lock & Lift: Art. no. **48 216**

14 Adhesive flange cannot be used with drain body
art. no. 45 740 for thin bed mortar seal
Art. no.: **48 410**

15 Fire-Kit fire protection only for drain bodies
Ecoguss® / Practicus® with vertical outlet
Art. no.: **48 100**

16 Quick Fit all-round seal for core drilling
(only for drain bodies **Ecoguss®** and **Practicus®**
with vertical outlet)
• with fire protection art. no.: **48 990**
• without fire protection art. no.: **48 991**

19 Bathroom drain **Giro** made of PP,
Side outlet Ø 50, side inlet Ø 50,
Flow rate 1,3 l/s
Art. no.: **45 101**

20 Bathroom drain „**Ultraflat**“ made of ABS
for thin mortar bed seal, side outlet Ø 40,
Flow rate 0,6 l/s
Art. no.: **45 740**

21 Bathroom drain „**Ultraflat**“ made of ABS,
Side outlet Ø 50, Ø 75,
Flow rate 1.0 l/s
Art. no.: Ø 50: **45 700**, Ø 75: **45 770**

22 Bathroom drain „**Ultraflat**“ made of ABS,
Side outlet Ø 50, side inlet Ø 40,
Flow rate 1.0 l/s
Art. no.: **45 701**

Lockable



Safe and simple locking using the Lock & Lift system, easy cleaning

Accessories



Hair sieve and Multistop (foam, rodent and odour stop) as accessories

Installation examples



Drain with connection edge and alternative seal

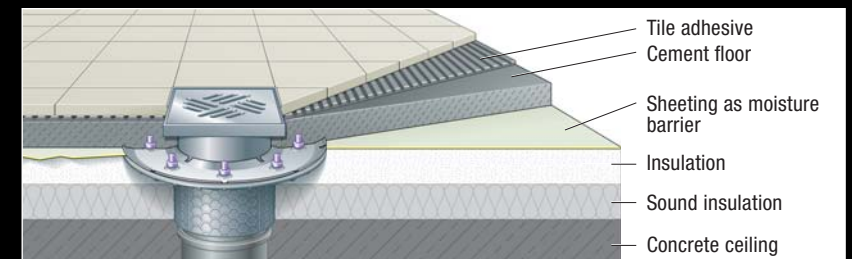

Seal through sealing sheet and pressure sealing flange

