

internal cove for ceramic wall coverings

ROUNDCOVE stainless steel internal cove profile is designed to ensure hygienic functions in all areas subject to sanitary inspection. Thanks to its internal curvature and to the characteristics of the used material, it perfectly meets the hygiene requirements and applications expected in hospitals, public and food processing plants, public toilets and other required areas. This profile is to be installed during laying, providing a neat finish at the same level with the adjacent tiled surfaces.

Illustrated scale dimension 1:1,2

roundcove™ RI/RF

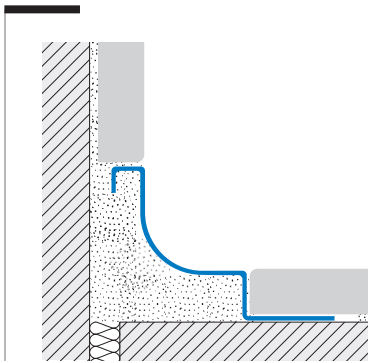

ROUNDCOVE RI-IL Polished Stainless Steel AISI 304 - DIN 1.4301

Internal cove profile to be installed while tiling between two tiled walls. Stainless steel AISI 304 standard ensures high resistance against most diluted chemicals and detergents, being then ideal for food processing plants, sanitary, chemical and hospital sectors. Very good mechanical resistance.

Material: Polished Stainless steel AISI 304

Length: 2,70 meters

Surface with protection film

Corner jointing pieces internal / external / three-way. Code: RII / RIE / RIT

ROUNDCOVE RF-IL Polished Stainless Steel AISI 304 - DIN 1.4301

Internal cove profile conceived to cover an existing tiled surface, to be installed while flooring. Stainless steel AISI 304 standard ensures high resistance against most diluted chemicals and detergents, being then ideal for food processing plants, sanitary, chemical and hospital sectors. Very good mechanical resistance.

Material: Polished Stainless steel AISI 304

Length: 2,70 meters

Surface with protection film

Jointing corner pieces internal / external also available Code: RFI / RFE

Perforated flange layed at wall with codes RFIR and RFER

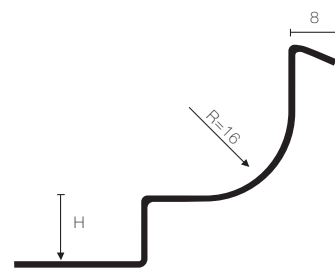

| H=mm | Art. |
|------|-----------|
| 8 | RI 80 IL |
| 10 | RI 100 IL |
| 12,5 | RI 125 IL |

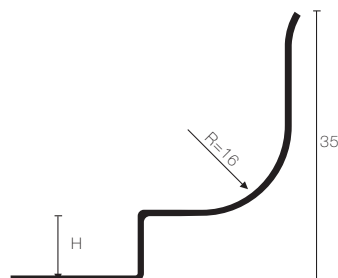

| H=mm | Art. |
|------|-----------|
| 10 | RF 100 IL |
| 12,5 | RF 125 IL |