

joining coving between floor and wall

folosani™ IC

FOLOSANI IC is a production series conceived to create the hygienic joint cove between wall and floor or between two walls vertically, in particular in hospitals, chemical and food industry environments. The product is supplied ready to be fixed onto existing coverings so it is suitable for restructuring jobs and complies with the current sanitary and safety norms and regulations. The round moulded body of this profile ensures an excellent contour hold. The H 60 model serves also as wall skirting. Suggested application with our special adhesive. Illustrated scale dimension 1:1,2

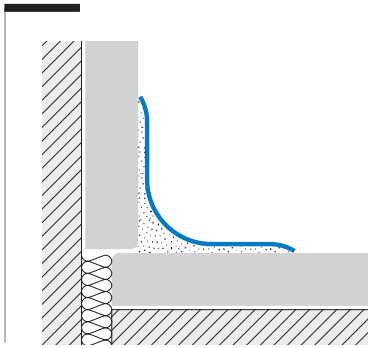

FOLOSANI IC-ILN Polished Stainless Steel AISI 304 - DIN 1.4301

The stainless steel quality of this cove base profile ensures a long lasting resistance to most of diluted chemical agents, hence it is considered ideal for food processing, hospitals and laboratory environments. Great tolerance to mechanical stress.

Material: Polished Stainless steel AISI 304
Length: 2,70 meters
Surface with protection film strip

IC 35: jointing corner pieces internal / external / three-way. Code ICI / ICE / ICT
IC 60: jointing corner pieces internal / external also available. Code ICI / ICE

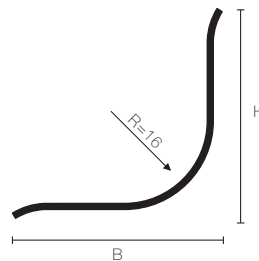

BxH	Art.
35x35	IC 35 ILN
32x60	IC 60 ILN

FOLOSANI IC 60 P 11 Synthetic Resin

Full body pure white resin UV stabilized wide cove base profile. It is utilized in diverse environments because it is resistant to most conventional diluted chemical agents and to minor scratches.

Material: Resintop
Colour: Pure White
Length: 2,70 meters

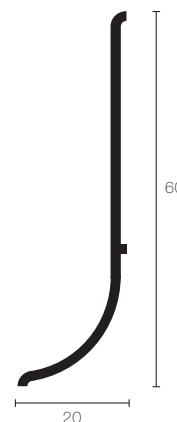

BxH	Art.
20x60	IC 60 P11