



# OPERATING INSTRUCTIONS

## FOR THE Z-Flex CURVER

The hand operated mechanical bending machine for DURAL profiles that have the Z-Flex punched flange

Using the Z-Flex CURVER it is possible to simply bend a range of DURAL profiles that incorporate the Z-Flex punched flange. These special profiles include DUROSOL, DURAPLUS, DURONDELL, DURATRANS and T-FLOOR.

### The Z-Flex CURVER consists of:

The protective hood 1, the bending wheel 2, adjustable with the turning knob 5, the moveable guide wheel 3, two holding wheels 4, and two additional flat holding clamps 6

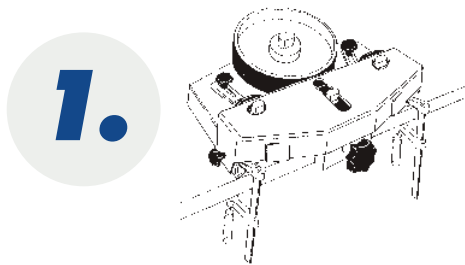
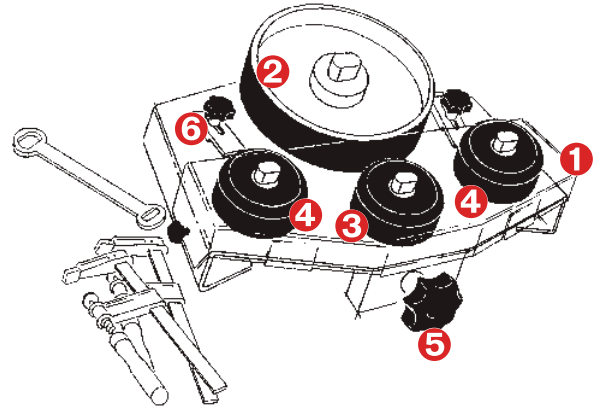

Z-Flex CURVER can easily be secured to a bench or work surfaces using the two CLAMPS.

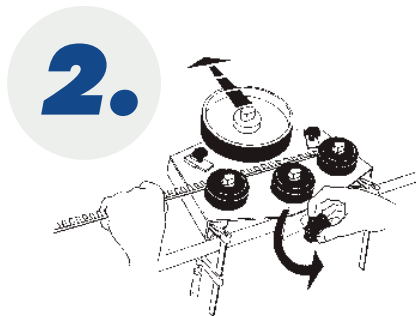

Firstly remove the PROTECTIVE HOOD. The large BENDING WHEEL is made to move forward and back when turning the FRONT KNOB. The two HOLDING WHEELS, including the two small additional FLAT HOLDING CLAMPS, act as the guide when the profile is placed in the Z-Flex CURVER. The first 15 cm allow for the profile to be bent manually or removed. However, should the distance be over 15 cm it is necessary to adjust the MOVEABLE GUIDE WHEEL, using the key provided.

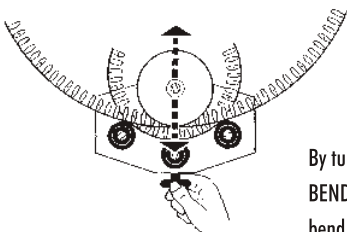

By turning the FRONT KNOB, the large BENDING WHEEL allows the profile to bend to the desired radius.



When the profile is placed into the Z-Flex CURVER, the two GUIDE WHEELS (4) are pressed against the profile and held in the desired position. By turning the FRONT KNOB (5), the LARGE BENDING WHEEL (2) is moved towards the two GUIDE WHEELS (4), claiming the profile in position. To avoid too much tension of the profile and possible damage to the LARGE BENDING WHEEL (2), the profile must be secured using the two FLAT HOLDING CLAMPS (6).

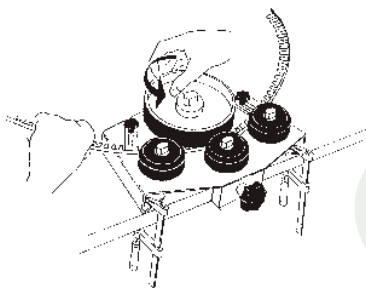

By turning the large BENDING WHEEL, and simultaneously guiding the profile, you can now produce the required radius as desired.

*Before use, pay attention 2. page!*





# OPERATING INSTRUCTIONS

## FOR THE Z-Flex CURVER

### Before use, pay attention!

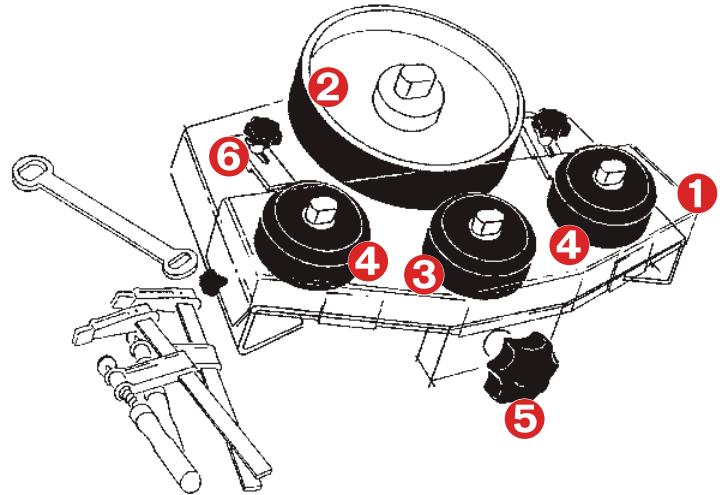

Should it be necessary to bend the profile to the outside you will need to relocate the two FLAT HOLDING CLAMPS ⑥. The MOVEABLE GUIDE WHEEL ③ and the two HOLDING WHEELS ④ have to have the bevelled side to the top. You will see in the diagram that these three wheels all have just one side bevelled.

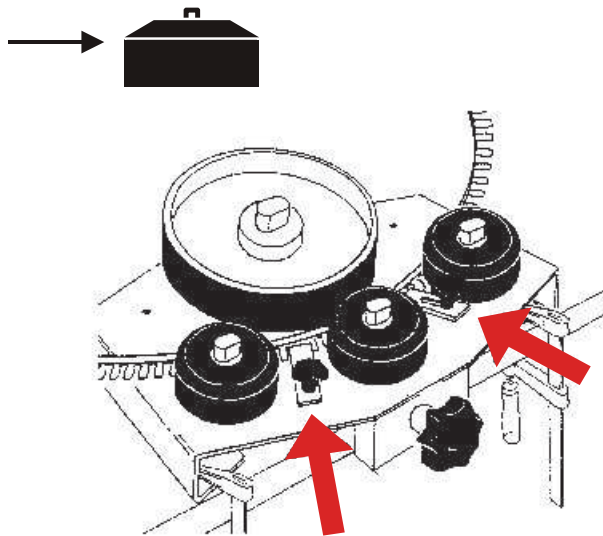

Profiles including DurosOL, DURAPLUS and T-FLOOR can be bent using the Z-Flex CURVER machine in its normal setting without turning over the three wheels. When using profiles such as DURATRANS and DURONDELL it will be necessary for the MOVEABLE GUIDE WHEEL ③ and the two HOLDING WHEELS ④ to be turned over thus exposing their bevelled side.

T-Floor (For bending to be placed to the lower side)

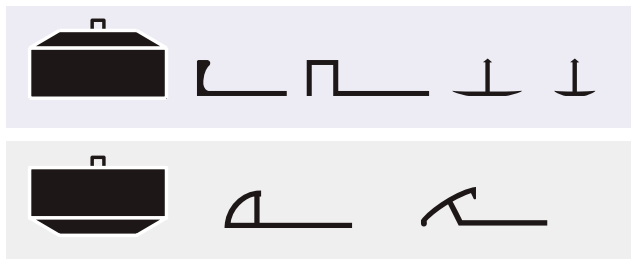

Procedure:

- Firstly remove the PROTECTIVE HOOD ① by slackening the front TURNING KNOB ⑤.
- Slacken the nuts on the three WHEELS ③ and ④, using the key provided.
- Turn these wheels over so that they are upside down, then re-tighten the nuts using the key. Replace the PROTECTIVE HOOD if necessary and secure with screws.

The Z-Flex CURVER is simple to operate and maintenance-free, however we do recommend that you clean the machine after use. Should you happen to loose or damage any of the parts of the CURVER we are pleased to offer a range of spares. The parts available are as follows:

- |                                  |                                     |
|----------------------------------|-------------------------------------|
| ① Protective hood no. 08 125 001 | ④ Holding wheels no. 08 125 003     |
| ② Bending wheel no. 08 125 002   | ⑤ Tuning knob no. 08 125 005        |
| ③ Moveable no. no. 08 125 003    | ⑥ Flat holding clamp no. 08 125 006 |

### Attention!

As some of the DURAL profiles are different in shape and configuration it is possible that the radius required can be different using the same adjustment by repeating the bending process using different profiles and simultaneously adjusting the two MOVEABLE GUIDE WHEELS, the desired radius is achieved by "approximation".



DURAL GmbH & Co. KG • Postfach 1348 • D - 56403 Montabaur

Tel. (+49) 0 26 02/92 61-0 • Fax (+49) 0 26 02/92 61-50 • email: welcome@dural.de • www.dural.com