

Architectural Expansion Joint Systems

REACT 500/600



React 500 Series

Seismic "Pop-Up" System for Floors and Walls

Joint Widths 25mm to 500mm

501-A01

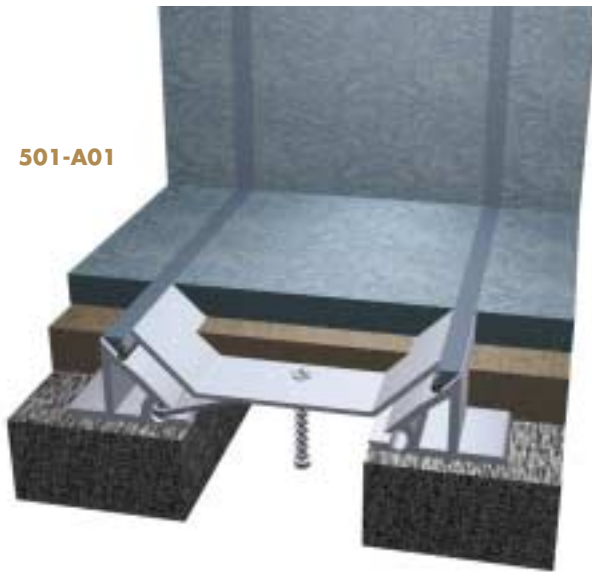

- Ideal for high grade marble, granite and limestone finishes
- "Zero sightline" system favored by interior designers
- Seal caulk matches grout lines
- Centering bar correctly repositions pan after movement
- Integrates floors and walls with the same system
- Easy onsite assembly and installation
- Patent applied for
- Load rated

OPTIONS Vapour Barrier
Fire Rated
Custom Pan Depths

Separate installation datasheet available

501-A01-100 Floor/Floor and Wall/Wall

Sealant Caulking

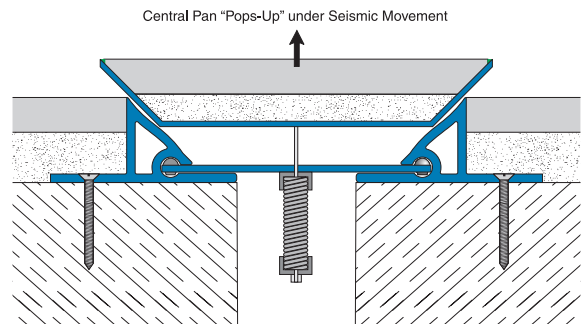
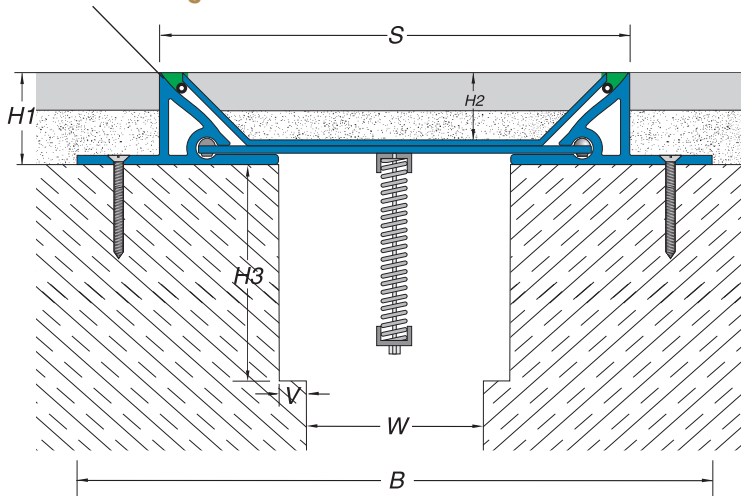

Application	Style	W	H1	H2	S	B	V	H3	Movement ±		Load
		Width	Height 1	Height 2	Sightline	Blockout	Undercut	Undercut	Horizontal	Vertical	
		mm	mm	mm	mm	mm	mm	mm	mm	mm	kN
Floor/Floor	501-A01-025	25	50	38	181	280	13	125	25	3	25
	501-A01-050	50	50	38	206	305	13	125	50	6	25
	501-A01-075	75	50	38	232	330	13	125	75	9	15
	501-A01-100	100	50	38	257	355	13	125	100	12	HP
	501-A01-150	150	50	38	308	410	13	125	150	19	HP
	501-A01-200	200	50	38	359	460	13	125	200	25	HP
Wall/Wall	501-A07-025	25	50	38	181	280	13	125	25	3	25
	501-A07-050	50	50	38	206	305	13	125	50	6	25
	501-A07-075	75	50	38	232	330	13	125	75	9	15
	501-A07-100	100	50	38	257	355	13	125	100	12	HP
	501-A07-150	150	50	38	308	410	13	125	150	19	HP
	501-A07-200	200	50	38	359	460	13	125	200	25	HP

Shear movement - unlimited.
For gap widths 201mm to 500mm, please contact the factory.

React 500 Series

Seismic "Pop-Up" System for Floor to Wall and Corner Wall

Joint Widths 25mm to 500mm

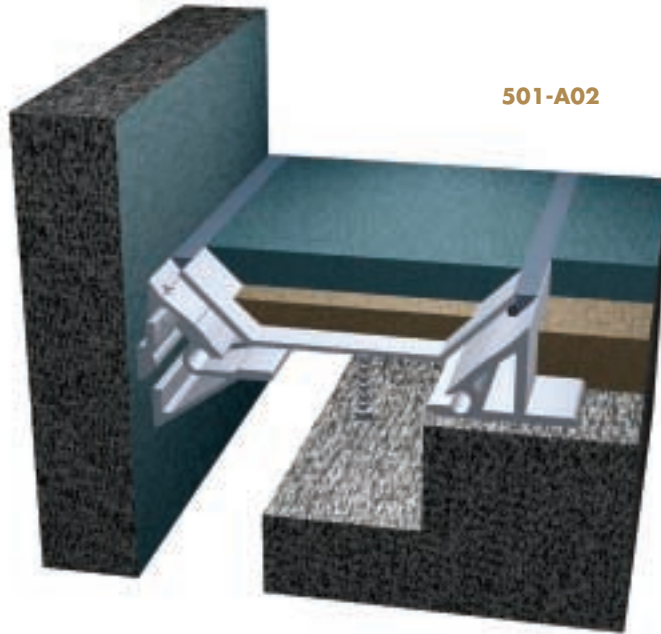

501-A02

501-A02-100 Floor/Wall and Wall/Corner

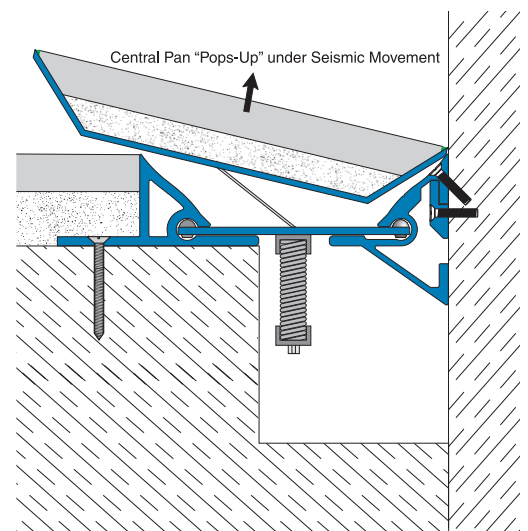
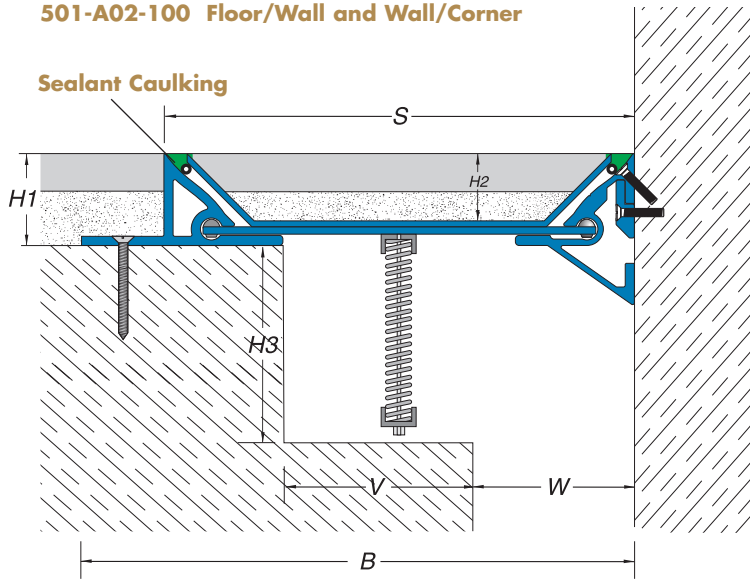

Application	Style	W	H1	H2	S	B	V	H3	Movement ±		Load
		Width	Height 1	Height 2	Sightline	Blockout	Undercut	Undercut	Horizontal	Vertical	
		mm	mm	mm	mm	mm	mm	mm	mm	mm	kN
Floor/Wall	501-A02-025	25	50	38	181	230	90	125	25	3	25
	501-A02-050	50	50	38	206	270	90	125	50	6	25
	501-A02-075	75	50	38	232	300	90	125	75	9	15
	501-A02-100	100	50	38	257	320	90	125	100	12	HP
	501-A02-150	150	50	38	308	370	90	200	150	19	HP
	501-A02-200	200	50	38	409	470	141	200	200	25	HP
Corner Wall	501-A09-025	25	50	38	181	230	90	125	25	3	25
	501-A09-050	50	50	38	206	270	90	125	50	6	25
	501-A09-075	75	50	38	232	300	90	125	75	9	15
	501-A09-100	100	50	38	257	320	90	125	100	12	HP
	501-A09-150	150	50	38	308	370	90	200	150	19	HP
	501-A09-200	200	50	38	409	470	141	200	200	25	HP

Shear movement - unlimited.
For gap widths 201mm to 500mm, please contact the factory.

React 600 Series

Wall and Ceiling Seismic Systems with Coloured Seals

Joint Widths 50mm to 600mm



616-A07 Wall/Wall

- Flush fit interior or exterior seismic wall system
- Adhesive or heat weld Santoprene seals for weather tight transitions
- 3 components for interior use, 4 components for exterior - additional back seal
- For gap widths greater than 100mm a centering bar system retains seals in place to resist wind load
- Patent number 508.042.8 applies

OPTIONS Fire Rated.

Separate installation datasheet available

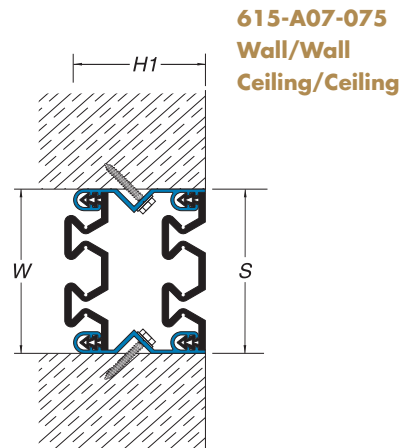
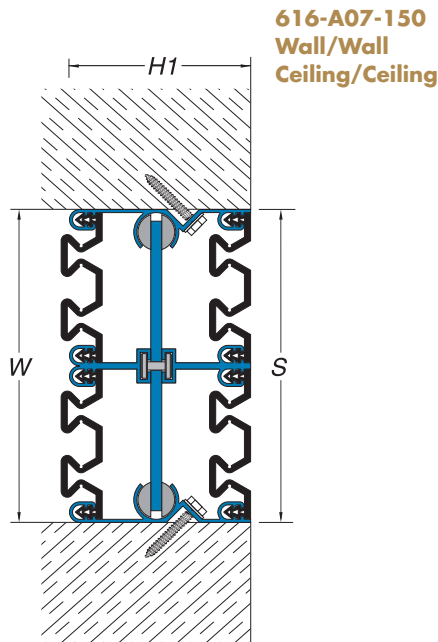

Application	Style	W Width mm	H1 Height mm	S Sightline mm	Movement ±	
					Horizontal mm	Vertical mm
Wall/Wall Ceiling/Ceiling	615-A07-050	50	65	50	25	25
	615-A07-075	75	65	75	38	38
	615-A07-100	100	65	100	50	50
Wall/Wall Ceiling/Ceiling	616-A07-150	150	100	150	75	75
	616-A07-200	200	100	200	100	100
	616-A07-300	300	100	300	150	150
Wall/Corner Ceiling/Wall	615-A09-050	50	65	50	25	25
	615-A09-075	75	65	75	38	38
	615-A09-100	100	65	100	50	50
Wall/Corner Ceiling/Wall	616-A09-150	150	100	150	75	75
	616-A09-200	200	100	200	100	100
	616-A09-300	300	100	300	150	150

For gap widths 301mm to 600mm, please contact the factory.

React 600 Series

Wall and Roof Seismic Systems

Joint Widths 25mm to 600mm

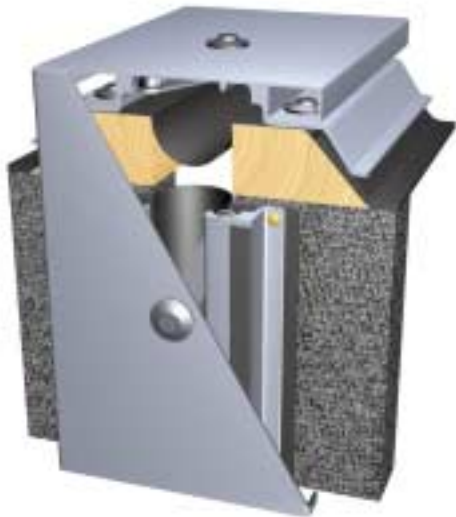

Wall/Roof Transition

- Easy onsite assembly and installation
- Multi-directional seismic movement
- Moisture barrier included
- **651** Wall system: surface mount
- **661** Roof system: surface mount
- Factory formed transitions

OPTIONS

Stainless Steel Plate

Fire Rated

Separate installation datasheet available

661-A01-050 Roof/Roof

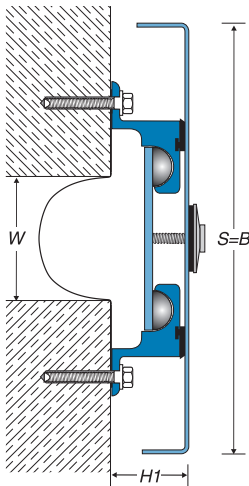
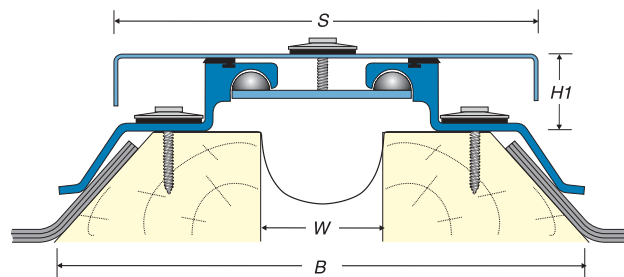

651-A07-050 Wall/Wall

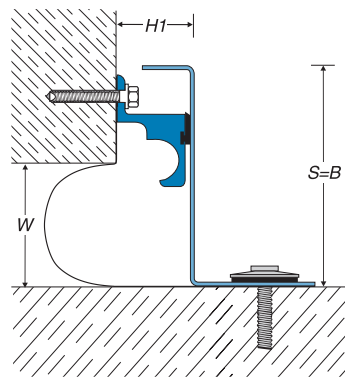

651-A09-050 Wall/Corner

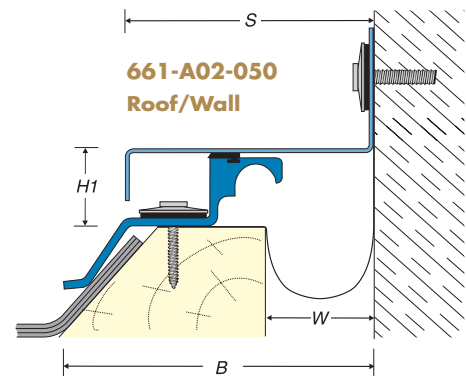

661-A02-050 Roof/Wall

Application	Style	W	H1	H2	S	B	Movement ±		Load
		Width mm	Height 1 mm	Height 2 mm	Sightline mm	Blockout mm	Horizontal mm	Vertical mm	
Wall/Wall	651-A07-025	25	32	.	107	.	12	12	.
	651-A07-050	50	32	.	133	.	25	25	.
	651-A07-100	100	32	.	184	.	50	50	.
	651-A07-150	150	32	.	234	.	75	75	.
	651-A07-200	200	32	.	311	.	100	100	.
	651-A07-300	300	32	.	463	.	150	150	.
Roof/Roof	661-A01-025	25	35	.	107	238	12	12	.
	661-A01-050	50	35	.	133	247	25	25	.
	661-A01-100	100	35	.	184	272	50	50	.
	661-A01-150	150	35	.	234	297	75	75	.
	661-A01-200	200	35	.	311	347	100	100	.
	661-A01-300	300	35	.	463	447	150	150	.
Wall/Corner	651-A09-025	25	32	.	66	.	12	12	.
	651-A09-050	50	32	.	92	.	25	25	.
	651-A09-100	100	32	.	142	.	50	50	.
	651-A09-150	150	32	.	193	.	75	75	.
Roof/Wall	661-A02-025	25	35	.	66	131	12	12	.
	661-A02-050	50	35	.	92	144	25	25	.
	661-A02-100	100	35	.	142	169	50	50	.
	661-A02-150	150	35	.	193	194	75	75	.

Shear movement - unlimited.

Products listed offer ±50% movement rating. Contact factory for 100% and wider joints. For gap widths 301mm to 600mm, please contact factory.

React 600 Series

Roof Seismic Systems

Joint Widths 50mm to 600mm

Roof/Roof Transition

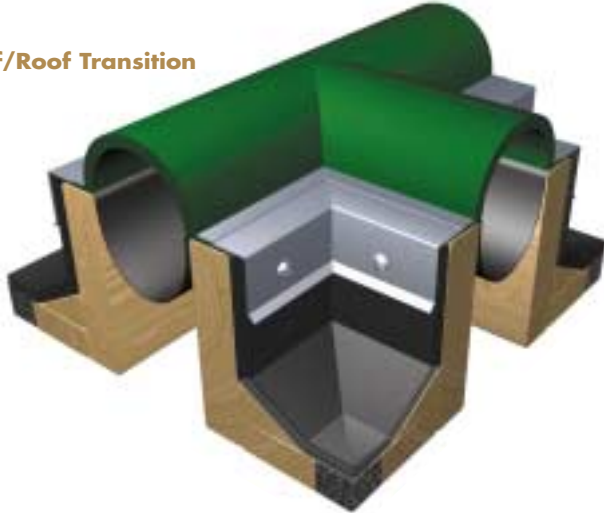

- Weatherproof roofing system that will remain watertight during the severest seismic events
- No secondary moisture barrier required
- Adhesive tabs for splicing and simple installation
- EPDM bellows with galvanized flanges standard

OPTIONS

- Bellows Available in Neoprene
- Factory Preformed Transitions
- Flanges Available in Stainless Steel, Aluminium or Copper
- 10ft/50ft Rolls

Separate installation datasheet available

672-A01
Roof/Roof

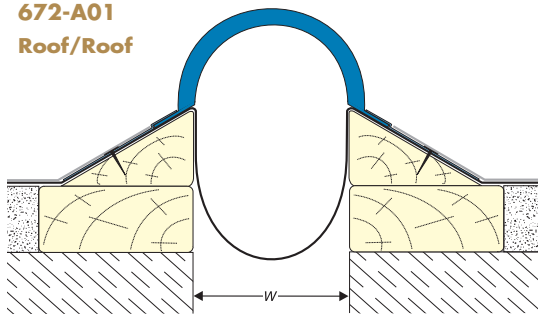

672-A02
Roof/Wall

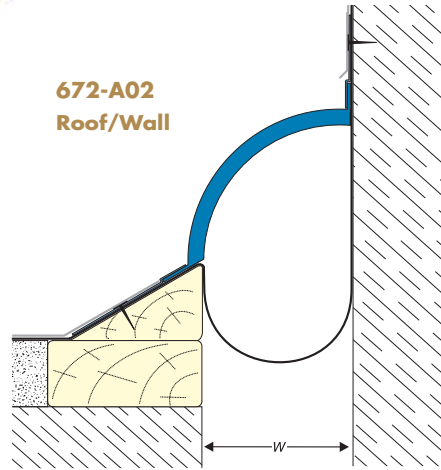

674-A01
Roof/Roof

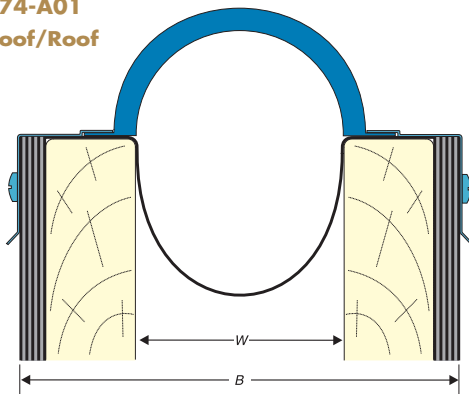

674-A02
Roof/Wall

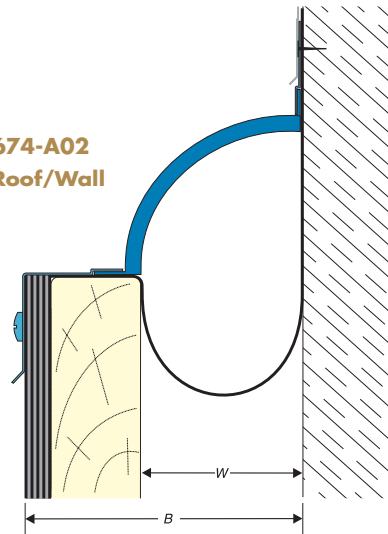

Application	Style	W Width mm	H1 Height 1 mm	H2 Height 2 mm	S Sightline mm	B Blockout mm	Movement ±		Load kN
							Horizontal mm	Vertical mm	
Roof/Roof Wall/Wall	672-A01-050	50	25	25	.
	672-A01-075	75	38	38	.
	672-A01-100	100	50	50	.
	672-A01-150	150	75	75	.
	672-A01-200	200	100	100	.
Roof/Roof	674-A01-050	50	.	.	.	144	25	25	.
	674-A01-075	75	.	.	.	169	38	38	.
	674-A01-100	100	.	.	.	194	50	50	.
	674-A01-150	150	.	.	.	244	75	75	.
	674-A01-200	200	.	.	.	294	100	100	.
Roof/Wall	674-A02-050	50	.	.	.	97	25	25	.
	674-A02-075	75	.	.	.	122	38	38	.
	674-A02-100	100	.	.	.	147	50	50	.
	674-A02-150	150	.	.	.	197	75	75	.
	674-A02-200	200	.	.	.	247	100	100	.

Shear movement - 25%.
 Products listed offer ±50% movement rating.
 For gap widths 201mm to 600mm, please contact factory.



VEXCOLT

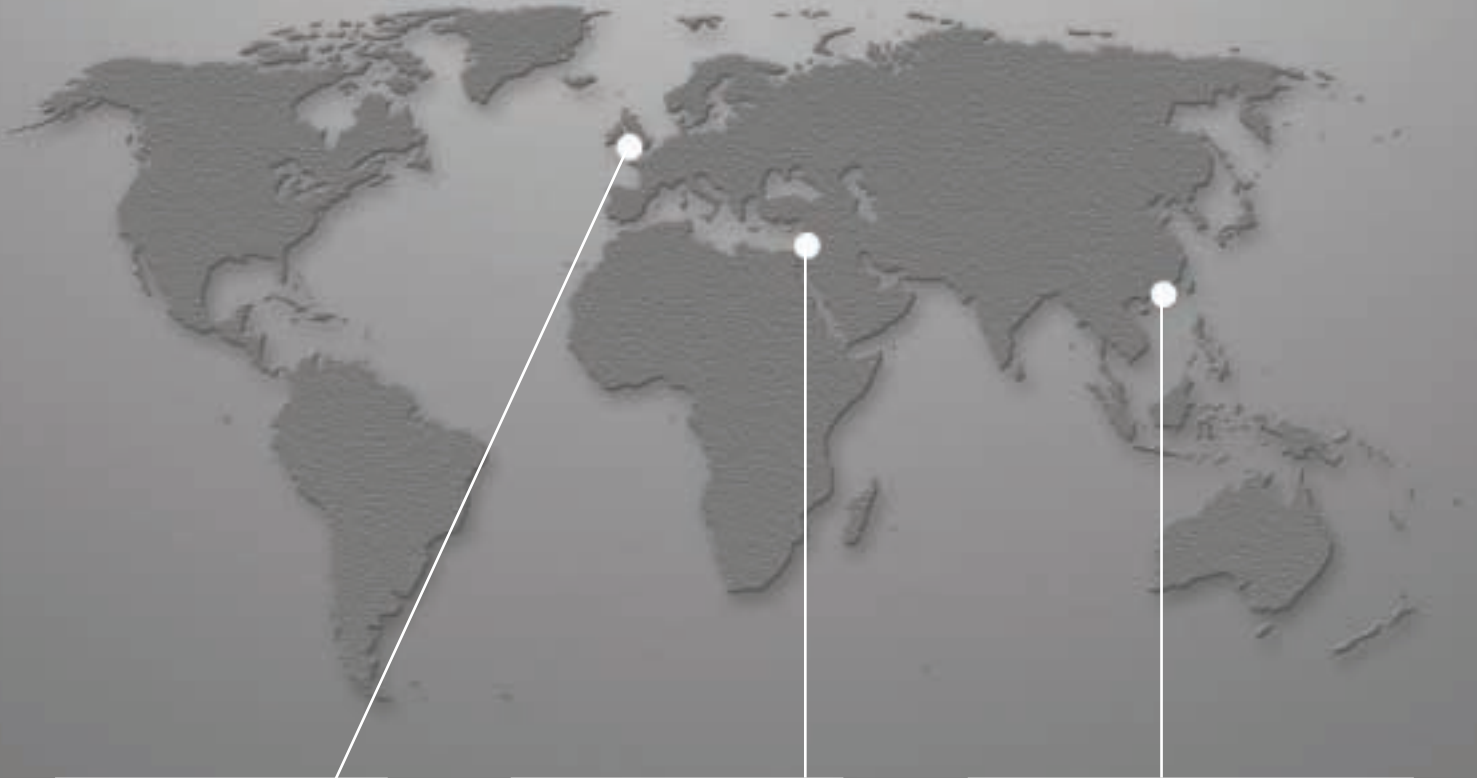

Vexcolt Europe

Summer House,
Summer Way,
Exeter,
England EX4 8JD

Tel: ++44 (0)1392 467567
Fax: ++44 (0)1392 467705
e-mail: info@vexcolt.com

Vexcolt Middle East

Sabah Building,
Memari Street,
Beirut,
Lebanon

Tel: ++961 1 738725
Fax: ++961 1 738731
e-mail: info@vexcoltme.com

Vexcolt Asia

Room E,
7th Floor Gold King Industrial Building,
35-41 Tai Lin Pai Road,
Kwai Chung,
N.T. Hong Kong

Tel: ++852 2420 2380
Fax: ++852 2420 2396
e-mail: info@vexcoltasia.com



© Vexcolt 2002 Issue date: 06/02

Vexcolt reserves the right to revise designs and specifications without notice. Information given in this booklet is correct to the best of our knowledge, but architects and specifiers must satisfy themselves as to the suitability of any particular product, specification or design detail for a specific application.

Acknowledgement: We would like to thank Sir Norman Foster and Partners for supplying and allowing us to use a picture of Chep Lap Airport, Hong Kong for the cover of this booklet.