

# SERIES FP 80/... NI

WITH SHORT AAS-SEALING SHEETS FOR FLOORS WITH COATINGS

## MIGUTAN

- **WATERTIGHT  
(OFFICIAL TEST CERTIFICATE)**
- **SEALING ON TOP OF SURFACE**
- **CENTRAL INSERT IS INTER-  
CHANGEABLE AT ANY TIME**
- **SMALL VISIBLE SURFACE**
- **PROPER AND ECONOMICAL  
FORMATION OF THE CONNECTION  
JOINT BY USING AAP 50/20**

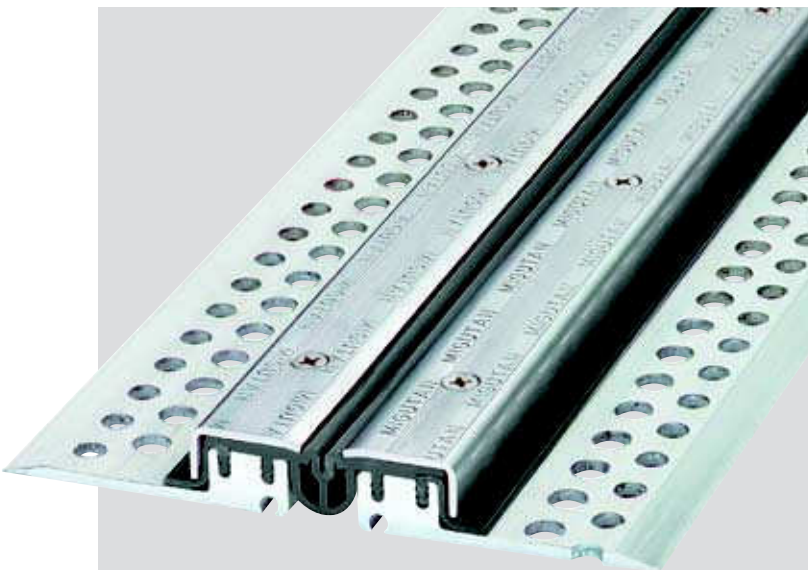

### TECHNICAL DATA

Profile	Joint width max. mm	Total movement mm	Visible width of profile	Total width of profile	Installation height mm	Load capacity lorries (DIN 1072) kN	Load capacity fork lift trucks (DIN 1055) kN	Load capacity solid plastic tyres kg/mm width of wheel
FP 80/ 25 NI	45	20 ± 10	82	209	25	600	130	6,5
FP 80/ 35 NI	45	20 ± 10	82	209	35	600	130	6,5
FP 80/ 45 NI	45	20 ± 10	82	198	46	300	70	not allowed
FP 80/ 60 NI	45	20 ± 10	82	209	60	300	30	not allowed
FP 80/ 80 NI	45	20 ± 10	82	209	81	120	30	not allowed
FP 80/ 95 NI	45	20 ± 10	82	209	97	60	not allowed	not allowed
FP 80/115 NI	45	20 ± 10	82	209	117	60	not allowed	not allowed

Profiles with an installation height from 60 mm upwards can be adjusted to higher load capacity. Please ask for our advice.

**Material description, important notes and special properties = Page 2**

**Column-/Wall-connections = Page 26–28**

**Terminations/Intersections = Page 40–45**

**Stainless Steel Cover Plates = Page 29**

**Further usage = Page 30–39**

**Installation instructions = Page 21**

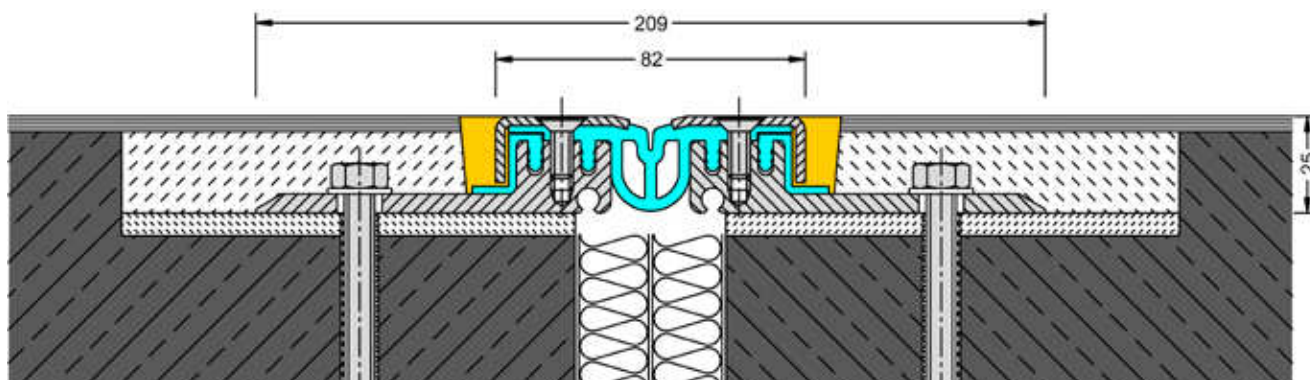

FP 80/25 NI

Scale 1 : 2